

FOR SALE/LEASE  
**FORMER ART VAN FURNITURE**

4095 E COURT ST, BURTON, MI 48509



# PROPERTY DETAILS

<b>LOCATION:</b>	4095 E Court St Bourton, MI 48509
<b>PROPERTY TYPE:</b>	Freestanding
<b>DATE AVAILABLE:</b>	Immediately
<b>PROPERTY TAXES:</b>	\$90,404.23 (2020)
<b>BUILDING SIZE:</b>	72,567 SF
<b>LOT SIZE:</b>	6.45 AC
<b>LOT DIMENSIONS:</b>	356' x 789'
<b>AVAILABLE SPACE:</b>	72,567 SF
<b>ZONING:</b>	C-2 (General Business)
<b>GLA:</b>	72,567 SF
<b>TRAFFIC COUNT:</b>	E Court ST (12,569 CPD) S Center St (21,751 CPD)

## EXCLUSIVELY LISTED BY:



**MATTHEW D. SWANTKO**  
Principal  
[mswantko@landmarkcres.com](mailto:mswantko@landmarkcres.com)  
248 488 2620



**GORDON S. HYDE**  
Senior Associate  
[ghyde@landmarkcres.com](mailto:ghyde@landmarkcres.com)  
248 488 2620



**MAX J. GOLDMAN**  
Senior Director  
[mgoldman@landmarkcres.com](mailto:mgoldman@landmarkcres.com)  
248 488 2620



**ANDREW C. LUCKOFF**  
Director  
[aluckoff@landmarkcres.com](mailto:aluckoff@landmarkcres.com)  
248 488 2620

6.45 AC

**LOT SIZE**

72,567 SF

**BLDG SIZE**

## TENANT ROSTER



## HIGHLIGHTS

- Former Art Van Furniture Store
- Situated on just North of the I-69 & Center Rd Interchange
- Located in Burton which is a Suburb of Flint, positioned just East of Flint in Genesee County
- Features 356' of Frontage Along East Court St

# MICRO AERIAL



# MACRO AERIAL

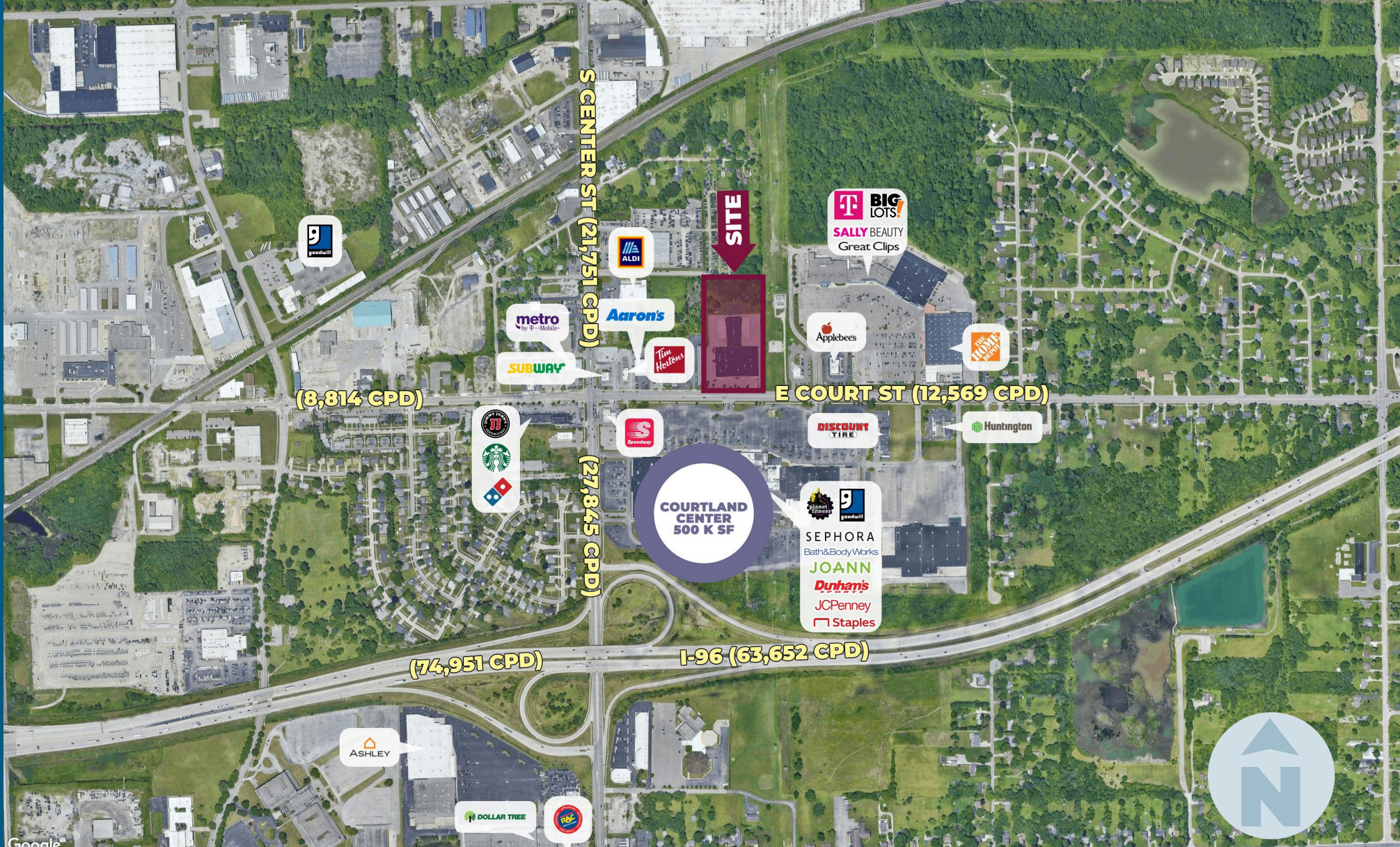



# DEMOGRAPHICS

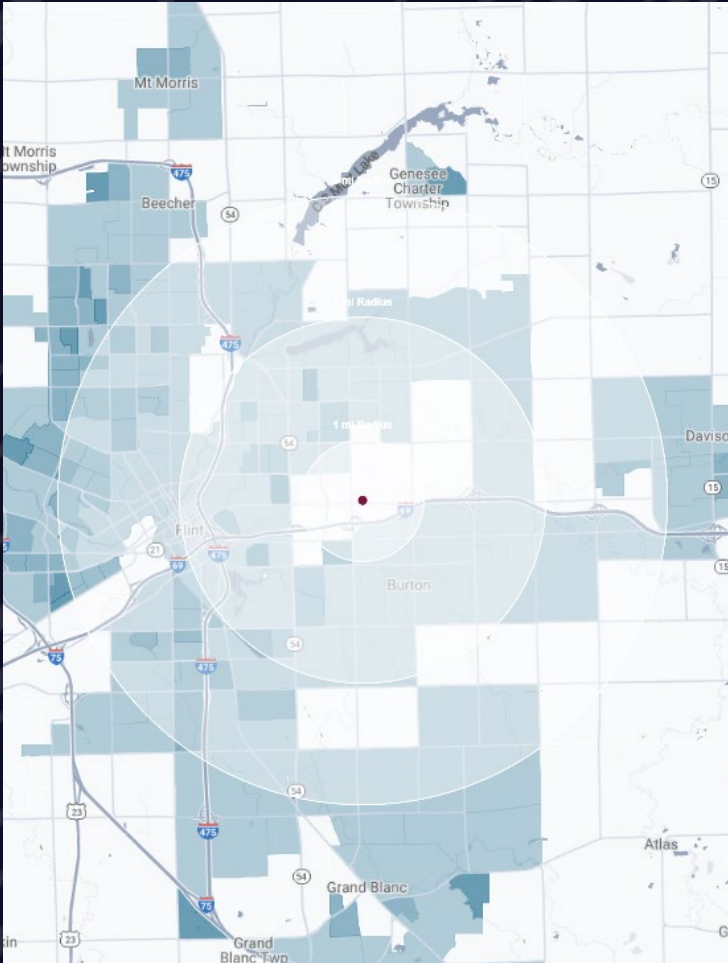

## FORMER ART VAN

4095 E Court St, Burton, MI 48509

# DEMOGRAPHICS

<b>POPULATION</b>	<b>1 MILE</b>	<b>3 MILE</b>	<b>5 MILE</b>
2023 Estimated Population	2,553	46,117	123,274
2028 Projected Population	2,251	42,135	114,836
2020 Census Population	2,576	47,463	124,762
2010 Census Population	2,840	53,414	142,565
Projected Annual Growth 2023 to 2028	-2.4%	-1.7%	-1.4%
Historical Annual Growth 2010 to 2023	-0.8%	-1.1%	-1.0%
<b>HOUSEHOLDS</b>			
2023 Estimated Households	1,083	19,815	51,193
2028 Projected Households	963	18,279	48,101
2020 Census Households	1,118	20,378	51,795
2010 Census Households	1,196	21,905	56,620
Projected Annual Growth 2023 to 2028	-2.2%	-1.6%	-1.2%
Historical Annual Growth 2010 to 2023	-0.7%	-0.7%	-0.7%
<b>RACE</b>			
2023 Est. White	45.7%	64.6%	61.8%
2023 Est. Black	48.0%	27.1%	30.2%
2023 Est. Asian or Pacific Islander	0.7%	1.0%	1.3%
2023 Est. American Indian or Alaska Native	0.3%	0.4%	0.3%
2023 Est. Other Races	5.4%	6.9%	6.4%
<b>INCOME</b>			
2023 Est. Average Household Income	\$69,305	\$70,133	\$70,444
2023 Est. Median Household Income	\$44,344	\$48,258	\$50,057
2023 Est. Per Capita Income	\$29,455	\$30,378	\$29,527
<b>BUSINESS</b>			
2023 Est. Total Businesses	223	1,699	3,439
2023 Est. Total Employees	2,126	17,993	41,162

## CONTACT US

**MS**

**MATTHEW D.  
SWANTKO**

*Principal*

[mswantko@landmarkcres.com](mailto:mswantko@landmarkcres.com)

248 488 2620

**GH**

**GORDON S.  
HYDE**

*Senior Associate*

[ghyde@landmarkcres.com](mailto:ghyde@landmarkcres.com)

248 488 2620

**MG**

**MAX J.  
GOLDMAN**

*Senior Director*

[mgoldman@landmarkcres.com](mailto:mgoldman@landmarkcres.com)

248 488 2620

**AL**

**ANDREW C.  
LUCKOFF**

*Director*

[aluckoff@landmarkcres.com](mailto:aluckoff@landmarkcres.com)

248 488 2620

**LANDMARK**  
COMMERCIAL ▲ REAL ESTATE ▲ SERVICES

30500 Northwestern Hwy, Suite 200  
Farmington Hills, MI 48334

248.488.2620

[landmarkcres.com](http://landmarkcres.com)

LANDMARK COMMERCIAL REAL ESTATE SERVICES – Licensed Real Estate Brokers. The information above has been obtained from sources believed reliable. While we do not doubt its accuracy, we have not verified it and make no guarantee, warranty or representation about it. It is your responsibility to independently confirm its accuracy and completeness. Any projections, opinions, assumptions or estimates are used for example only and do not represent the current or future performance of the property. The value of this transaction to you depends on tax and other factors which should be evaluated by your tax, financial and legal advisors. You and your advisors should conduct a careful, independent investigation of the property to determine to your satisfaction, the suitability of the property for your needs.