

FOR LEASE

PRIME ENDCAP OPPORTUNITY - CHESTERFIELD SQUARE

51347-51405 GRATIOT AVE, CHESTERFIELD, MI 48051



**3,300 SF
AVAILABLE**



**3,843 SF
AVAILABLE**

7 SALON SUITES



PROPERTY DETAILS

LOCATION: 51347-51405 Gratiot Ave
Chesterfield, MI 48051

PROPERTY TYPE: Shopping Center

DATE AVAILABLE: Immediately

RENT: Contact Broker

NNN EXPENSE: \$4.75/ SF

BUILDING SIZE: 66,420 SF

AVAILABLE SPACE: Inline: 3,300 SF
Endcap: 3,843 SF

ZONING: C-2

TRAFFIC COUNT: Gratiot Ave (28,010 CPD)
23 Mile Rd (19,913 CPD)

EXCLUSIVELY LISTED BY:



ANTHONY J. VITALE
Director
avitale@landmarkcres.com
248 488 2620



JOHN KELLO
Managing Director
jkello@landmarkcres.com
248 488 2620

Contact Broker

\$4.75/SF

RENT

NNN

TENANT ROSTER



DESCRIPTION

Chesterfield Square features an excellent opportunity to locate at the vibrant intersection of Gratiot Ave & 23 Mile Rd. This well-established community center is situated in a densely populated sub-regional market in the heart of one of Macomb County's major retail corridors which boasts traffic counts in excess of 37,000 vehicles per day.

SITE PLAN

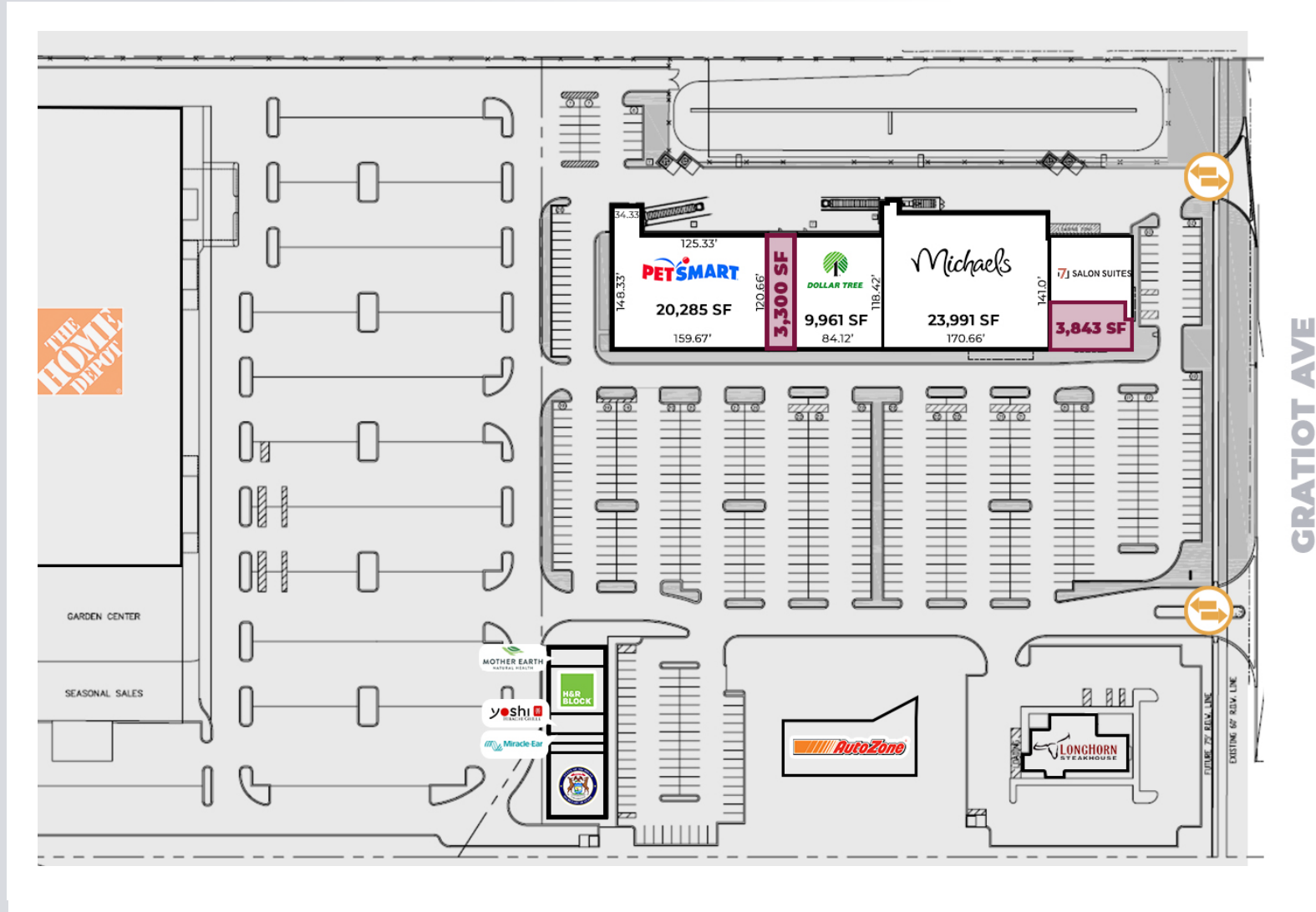

VIEW NORTHEAST



23 MILE RD
(19,913 CPD)

meijer

3,300 SF
AVAILABLE

3,843 SF
AVAILABLE

GRATIOT AVE
(24,030 CPD)

GRATIOT AVE
(28,010 CPD)

23 MILE RD
(27,993 CPD)

verizon
ATHLETICO
PHYSICAL THERAPY
SVS
VISION
Olgas
SMOOTHIE KING
Beaumont
Urgent Care

noodles
QDOBA
The Honey Bunch of Oats

MOTHER EARTH
HERB BLOCKS
yoshi
Miracle-Ear

THE HOME DEPOT

AutoZone

LONGHORN STEAKHOUSE

Michaels
PETSMART
DOLLAR TREE
17 SALON SUITES

BELLE TIRE

Little Caesars
ANYTIME FITNESS

T Mobile
tropical CAFE

VIEW EAST



GRATIOT AVE
(28,010 CPD)

3,300 SF
AVAILABLE

3,843 SF
AVAILABLE

23 MILE RD
(19,913 CPD)

GRATIOT AVE
(24,030 CPD)

23 MILE RD
(27,993 CPD)

VIEW SOUTHWEST



MACRO AERIAL

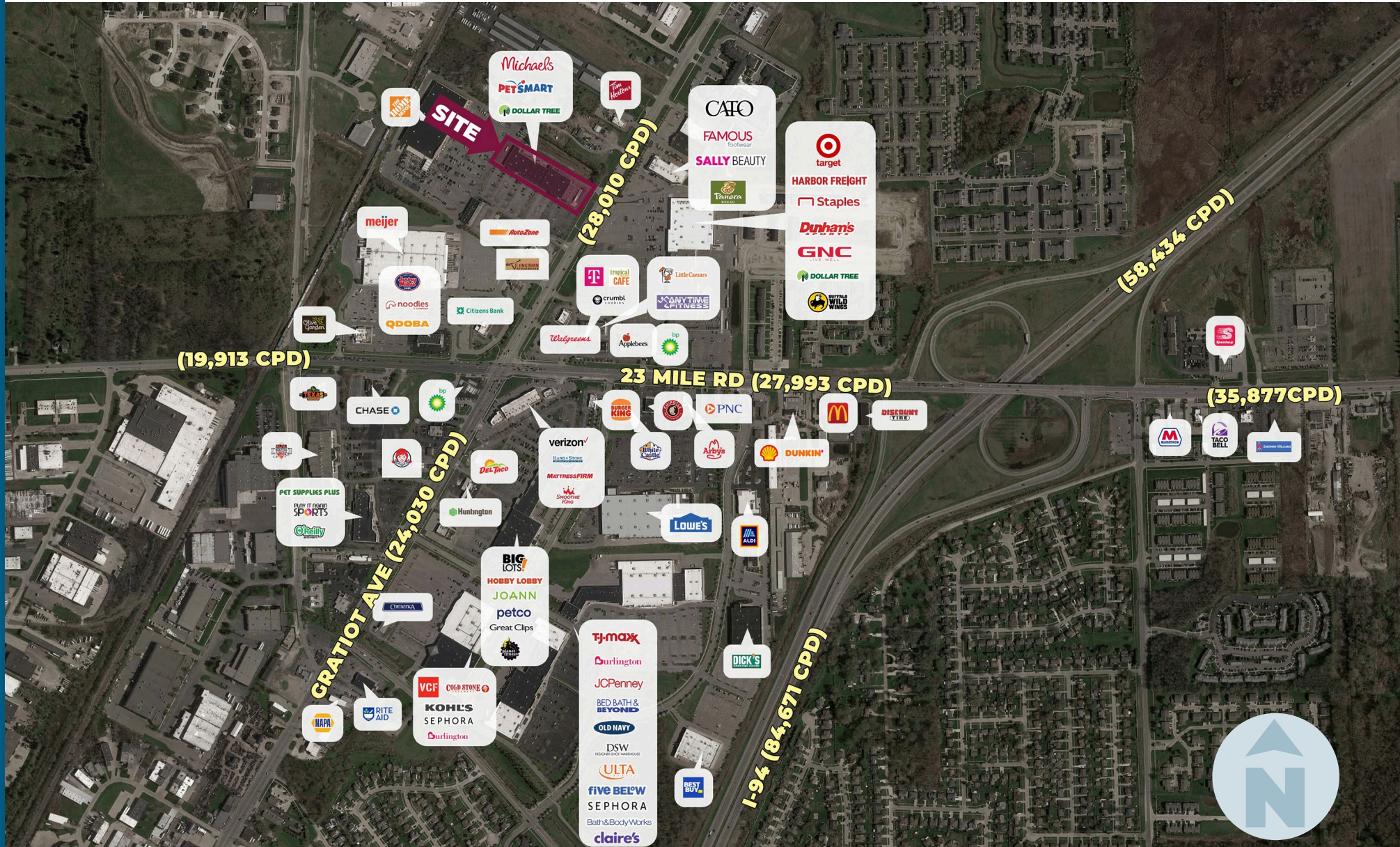

DEMOGRAPHICS

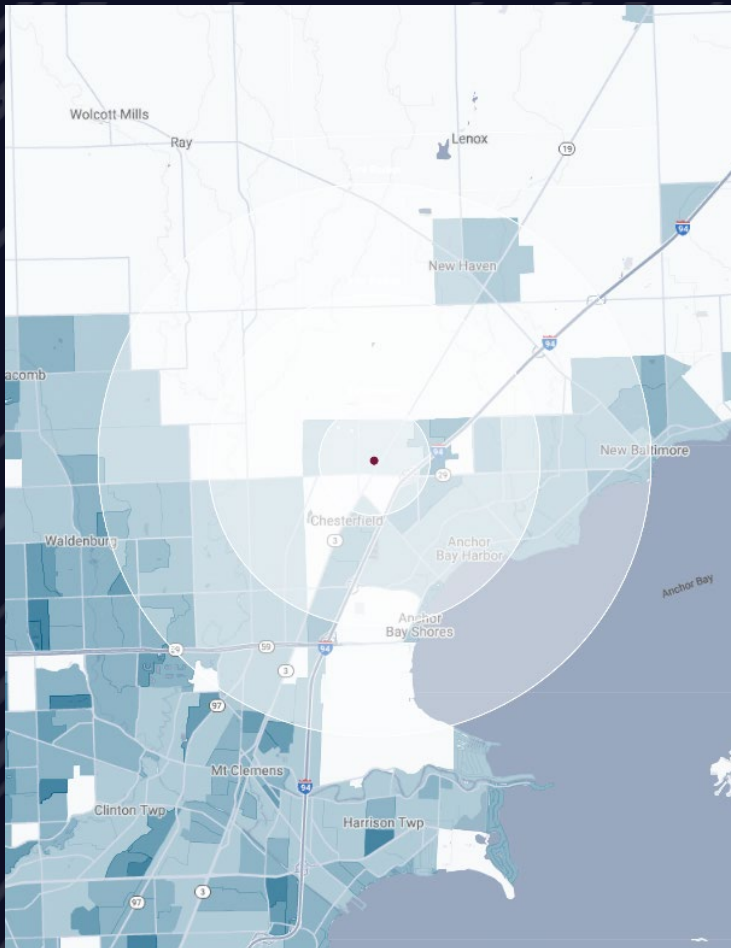

CHESTERFIELD SQUARE

51347-51405 Gratiot Ave
Chesterfield, MI 48051

DEMOGRAPHICS

POPULATION

	1 MILE	3 MILE	5 MILE
2023 Estimated Population	6,171	46,444	106,562
2028 Projected Population	7,209	50,784	117,464
2020 Census Population	5,673	43,336	101,204
2010 Census Population	5,104	39,368	91,586
Projected Annual Growth 2023 to 2028	3.4%	1.9%	2.0%
Historical Annual Growth 2010 to 2023	1.6%	1.4%	1.3%

HOUSEHOLDS

2023 Estimated Households	2,554	18,348	40,157
2028 Projected Households	2,978	20,064	44,156
2020 Census Households	2,270	16,685	36,823
2010 Census Households	1,953	14,591	32,384
Projected Annual Growth 2023 to 2028	3.3%	1.9%	2.0%
Historical Annual Growth 2010 to 2023	2.4%	2.0%	1.8%

RACE

2023 Est. White	78.2%	82.3%	80.2%
2023 Est. Black	12.8%	10.0%	11.2%
2023 Est. Asian or Pacific Islander	2.5%	2.5%	3.1%
2023 Est. American Indian or Alaska Native	0.2%	0.2%	0.2%
2023 Est. Other Races	6.3%	5.1%	5.3%

INCOME

2023 Est. Average Household Income	\$83,838	\$111,651	\$115,374
2023 Est. Median Household Income	\$67,988	\$94,566	\$96,346
2023 Est. Per Capita Income	\$34,703	\$44,129	\$43,660

BUSINESS

2023 Est. Total Businesses	287	1,171	2,600
2023 Est. Total Employees	3,079	12,212	28,903

CONTACT US



**ANTHONY J.
VITALE**

Director

avitale@landmarkcres.com
248 488 2620



**JOHN
KELLO**

Managing Director

jkello@landmarkcres.com
248 488 2620

LANDMARK
COMMERCIAL ▲ REAL ESTATE ▲ SERVICES

30500 Northwestern Hwy, Suite 200
Farmington Hills, MI 48334
248.488.2620
landmarkcres.com

LANDMARK COMMERCIAL REAL ESTATE SERVICES – Licensed Real Estate Brokers. The information above has been obtained from sources believed reliable. While we do not doubt its accuracy, we have not verified it and make no guarantee, warranty or representation about it. It is your responsibility to independently confirm its accuracy and completeness. Any projections, opinions, assumptions or estimates are used for example only and do not represent the current or future performance of the property. The value of this transaction to you depends on tax and other factors which should be evaluated by your tax, financial and legal advisors. You and your advisors should conduct a careful, independent investigation of the property to determine to your satisfaction, the suitability of the property for your needs.