

FOR SALE

FREESTANDING RETAIL BUILDING (FORMER RESTAURANT)

7750 METROPOLITAN PARKWAY, STERLING HEIGHTS, MI 48321



PROPERTY DETAILS

7,475 SF

AVAILABLE SPACE

LOCATION:	7750 Metropolitan Parkway, Sterling Heights, MI 48312
PROPERTY TYPE:	Freestanding Building
DATE AVAILABLE:	\$31,487.77 (2016)
BUILDING SIZE:	7,475 SF
AVAILABLE SPACE:	7,475 SF
LOT SIZE:	1.5 AC
ZONING:	C-3
TRAFFIC COUNT:	Metropolitan Parkway (61,124 CPD) Van Dyke Ave (54,355 CPD)



HIGHLIGHTS

- Located at one of Macomb County's busiest intersections with Home Depot and Meijer (SWC OF METROPOLITAN PARKWAY & VAN DYKE AVENUE)
- Freestanding Former Restaurant Building situated on 1.5 Acres
- Multiple Access Points from both Van Dyke Avenue and Metro Parkway
- Many New Developments in close proximity to this site
- Large Pylon Sign
- 110 Car Parking

EXCLUSIVELY LISTED BY:



ANTHONY J. VITALE
Director
avitale@landmarkcres.com
248 488 2620



LOUIS J. CIOTTI
Managing Director
lciotti@landmarkcres.com
248 488 2620



SCOTT J. SONENBERG
Director
ssonenberg@landmarkcres.com
248 488 2620

MICRO AERIAL

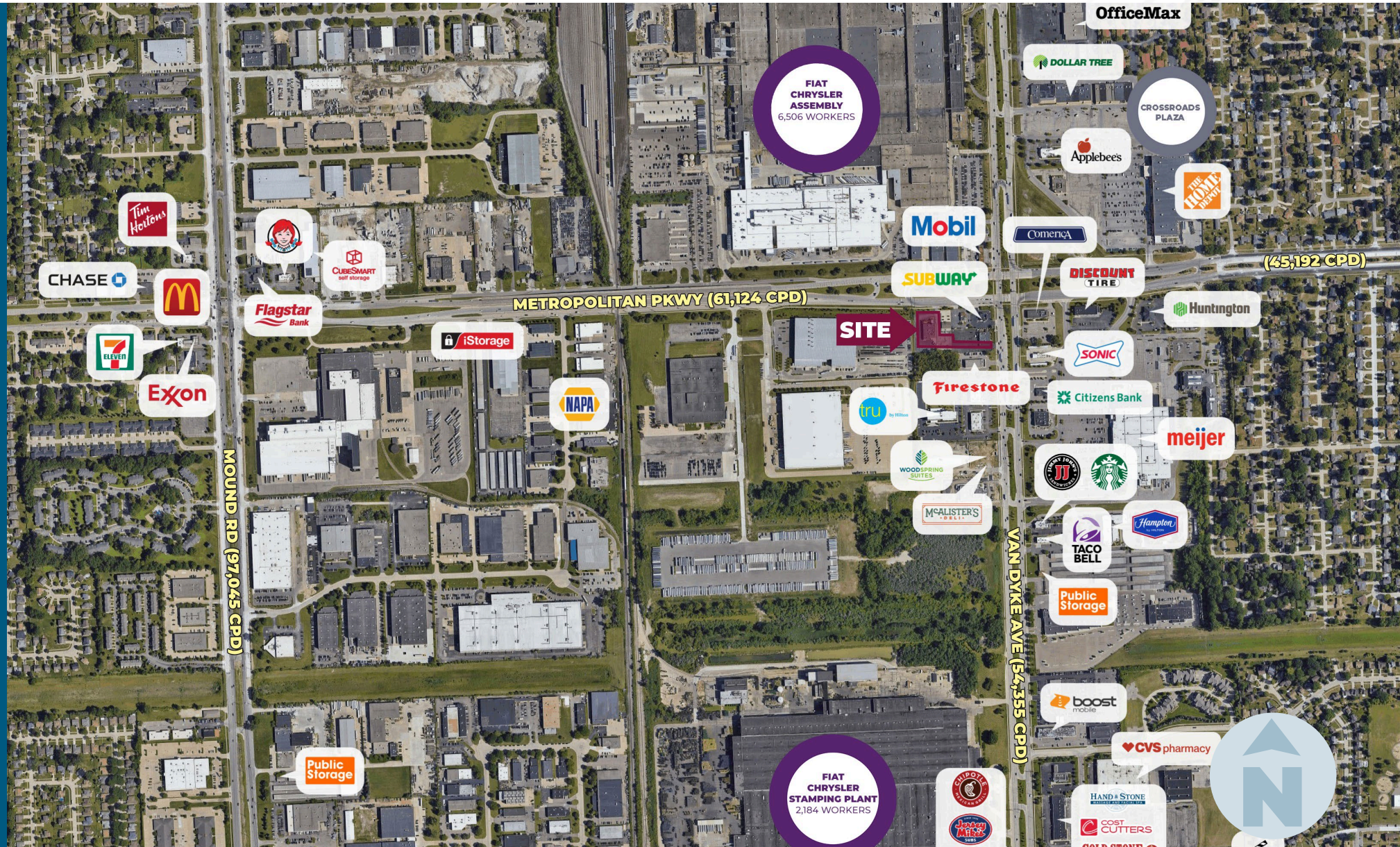

MACRO AERIAL

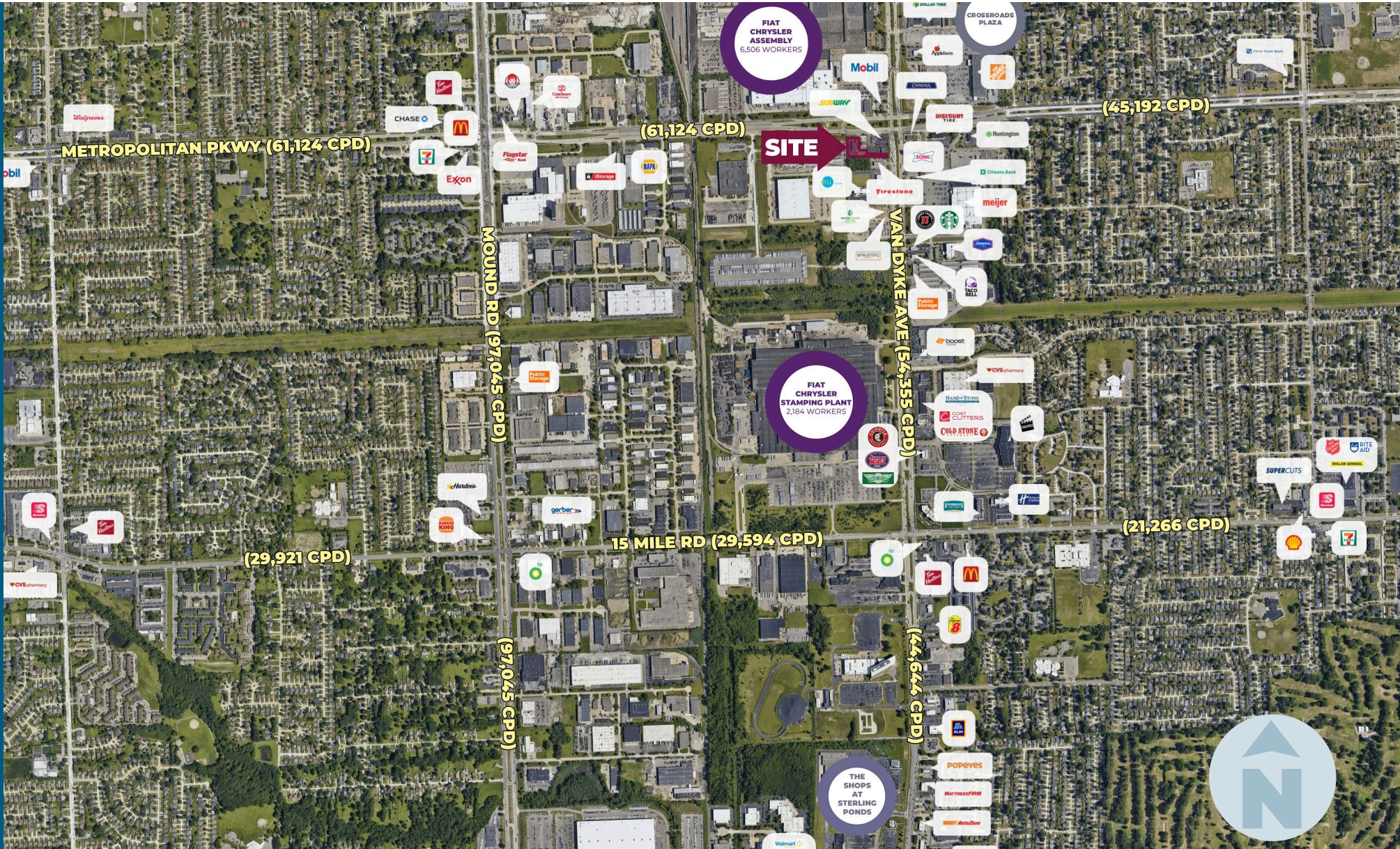

AERIAL

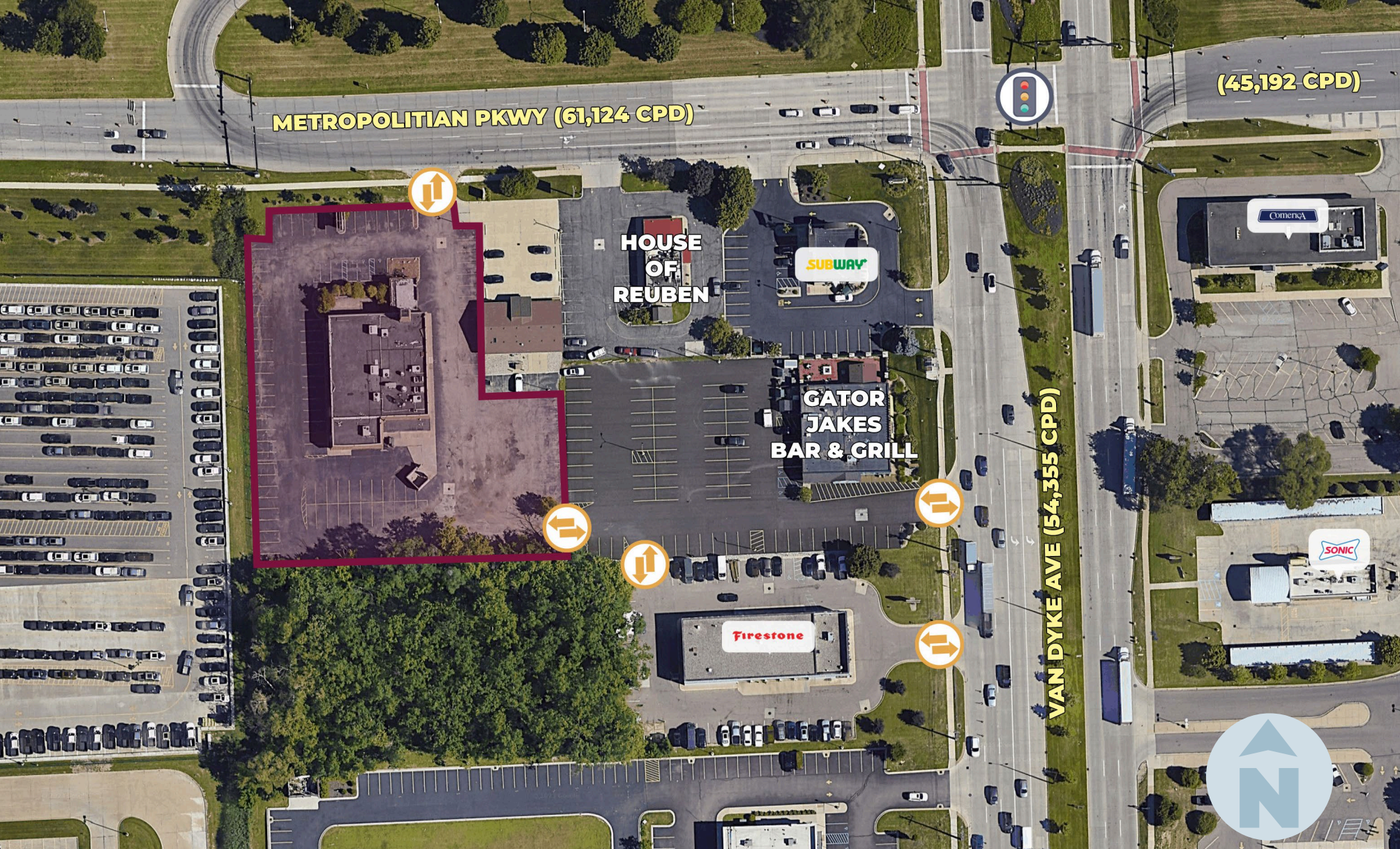

DEMOGRAPHICS



FREESTANDING RETAIL BUILDING

7750 Metropolitan Parkway,
Sterling Heights, MI 48312

DEMOGRAPHICS

POPULATION

	1 MILE	3 MILE	5 MILE
2023 Estimated Population	5,261	97,427	288,319
2028 Projected Population	5,239	96,057	287,263
2020 Census Population	5,256	98,544	290,492
2010 Census Population	5,134	95,925	279,607
Projected Annual Growth 2023 to 2028	-	-0.3%	-
Historical Annual Growth 2010 to 2023	0.2%	0.1%	0.2%

HOUSEHOLDS

2023 Estimated Households	2,220	37,843	117,931
2028 Projected Households	2,251	37,882	119,075
2020 Census Households	2,193	37,821	117,301
2010 Census Households	2,146	36,601	112,197
Projected Annual Growth 2023 to 2028	0.3%	-	0.2%
Historical Annual Growth 2010 to 2023	0.3%	0.3%	0.4%

RACE

2023 Est. White	79.0%	79.3%	76.9%
2023 Est. Black	8.6%	8.4%	9.4%
2023 Est. Asian or Pacific Islander	8.1%	8.5%	9.4%
2023 Est. American Indian or Alaska Native	-	0.1%	0.1%
2023 Est. Other Races	4.3%	3.7%	4.1%

INCOME

2023 Est. Average Household Income	\$106,089	\$96,302	\$100,999
2023 Est. Median Household Income	\$70,224	\$73,448	\$76,176
2023 Est. Per Capita Income	\$44,921	\$37,472	\$41,393

BUSINESS

2023 Est. Total Businesses	453	3,028	10,655
2023 Est. Total Employees	8,733	40,234	138,814

CONTACT US



**ANTHONY J.
VITALE**

Director

avitale@landmarkcres.com
248 488 2620



**LOUIS J.
CIOTTI**

Managing Director

lciotti@landmarkcres.com
248 488 2620



**SCOTT J.
SONENBERG**

Director

ssonenberg@landmarkcres.com
248 488 2620

LANDMARK
COMMERCIAL ▲ REAL ESTATE ▲ SERVICES

30500 Northwestern Hwy, Suite 200
Farmington Hills, MI 48334
248.488.2620
landmarkcres.com

LANDMARK COMMERCIAL REAL ESTATE SERVICES – Licensed Real Estate Brokers. The information above has been obtained from sources believed reliable. While we do not doubt its accuracy, we have not verified it and make no guarantee, warranty or representation about it. It is your responsibility to independently confirm its accuracy and completeness. Any projections, opinions, assumptions or estimates are used for example only and do not represent the current or future performance of the property. The value of this transaction to you depends on tax and other factors which should be evaluated by your tax, financial and legal advisors. You and your advisors should conduct a careful, independent investigation of the property to determine to your satisfaction, the suitability of the property for your needs.