

FOR LEASE FORMER ELDER-BEERMAN

3311 SECOR RD, TOLEDO, OH



PROPERTY DETAILS

61,340 SF

AVAILABLE SPACE

LOCATION:	3311 Secor Rd, Toledo, OH, 43606
PROPERTY TYPE:	Shopping Center
BUILDING DIMENSIONS:	290' X 207'
AVAILABLE SPACE:	61,340 SF
GROSS LEASABLE AREA:	61,340 SF
ZONING:	CR Regional
TRAFFIC COUNT:	Secor Rd (20,950 CPD)

EXCLUSIVELY LISTED BY:



DAVID M. WARD
Director
dward@landmarkcres.com
248 488 2620



DANIEL H. KUKEL
Principal
dkukes@landmarkcres.com
248 488 2620

HIGHLIGHTS

- Located at the SEQ of Center Avenue and Secor Road. This redevelopment of the former Elder-Beerman Department store will go under construction in 2019. The trade area surrounding the site has over 250,000 people and draws from multiple surrounding counties. University of Toledo enrollment of 18,000 undergraduate students and 4,200 graduate students is south of the shopping center.
- Please call us with your specific requirements.

MICRO AERIAL



SITE PLAN

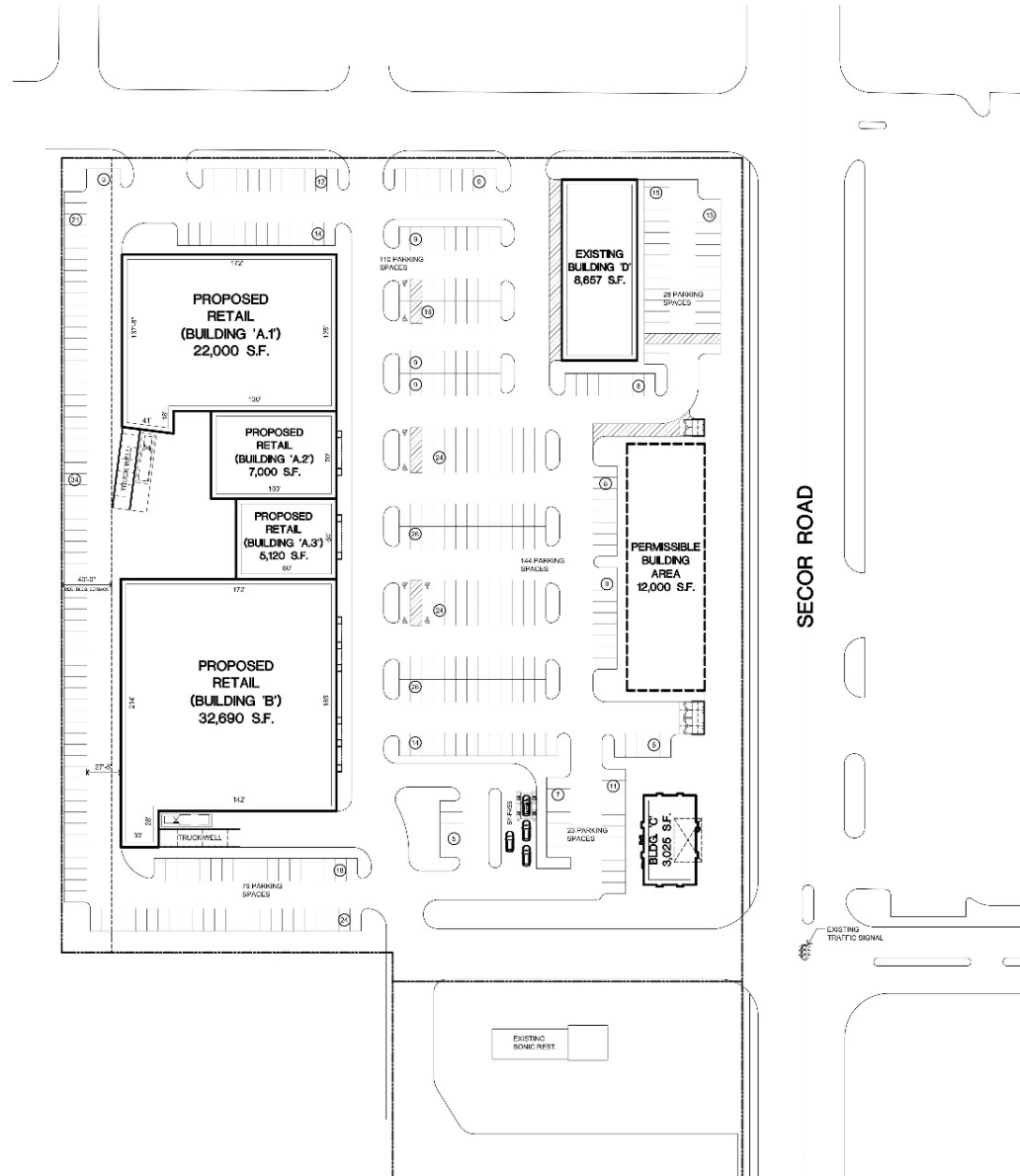

DEMOGRAPHICS

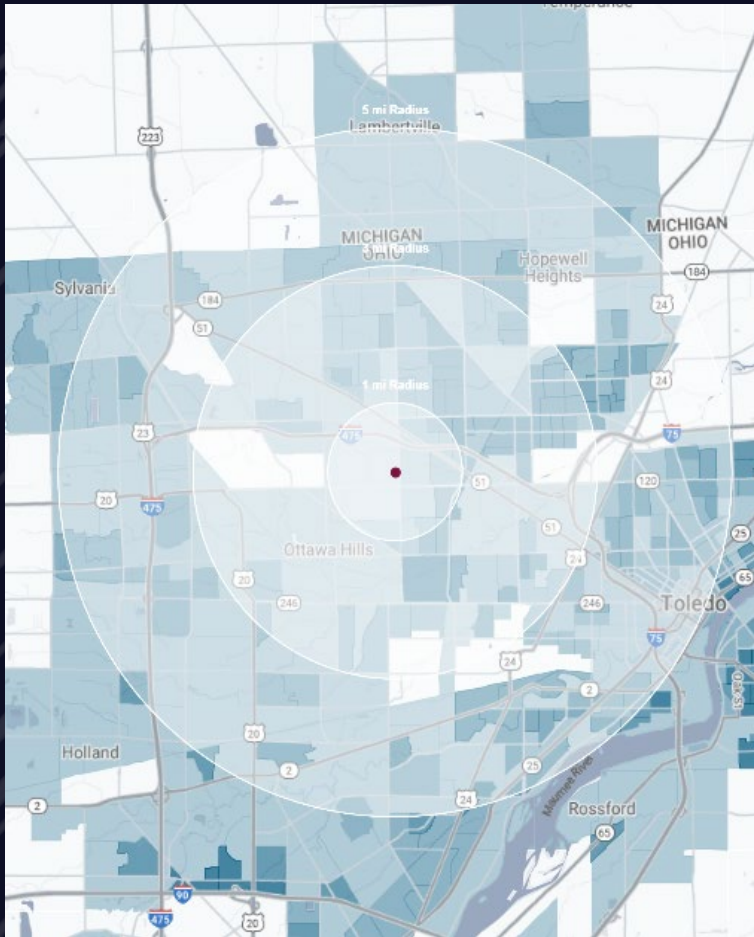

FORMER ELDER-BEERMAN

3311 Secor Rd, OH, 43606

DEMOGRAPHICS

POPULATION

	1 MILE	3 MILE	5 MILE
2023 Estimated Population	11,589	102,150	240,175
2028 Projected Population	11,310	100,331	237,110
2020 Census Population	11,837	103,600	242,583
2010 Census Population	11,944	106,012	253,907
Projected Annual Growth 2023 to 2028	-0.5%	-0.4%	-0.3%
Historical Annual Growth 2010 to 2023	-0.2%	-0.3%	-0.4%

HOUSEHOLDS

2023 Estimated Households	5,705	44,571	104,837
2028 Projected Households	5,436	42,812	101,336
2020 Census Households	5,736	44,696	104,698
2010 Census Households	5,599	44,456	105,773
Projected Annual Growth 2023 to 2028	-0.9%	-0.8%	-0.7%
Historical Annual Growth 2010 to 2023	0.1%	-	-

RACE

2023 Est. White	74.1%	62.6%	62.9%
2023 Est. Black	16.9%	24.6%	26.0%
2023 Est. Asian or Pacific Islander	2.8%	5.8%	3.4%
2023 Est. American Indian or Alaska Native	0.2%	0.2%	0.3%
2023 Est. Other Races	6.0%	6.8%	7.5%

INCOME

2023 Est. Average Household Income	\$91,338	\$83,359	\$78,632
2023 Est. Median Household Income	\$69,616	\$62,230	\$58,768
2023 Est. Per Capita Income	\$45,115	\$36,633	\$34,547

BUSINESS

2023 Est. Total Businesses	785	3,803	9,125
2023 Est. Total Employees	8,464	40,837	106,524

CONTACT US



**DAVID M.
WARD**

Director

dward@landmarkcres.com

248 488 2620



**DANIEL H.
KUKES**

Principal

dkukes@landmarkcres.com

248 488 2620

LANDMARK
COMMERCIAL ▲ REAL ESTATE ▲ SERVICES

30500 Northwestern Hwy, Suite 200
Farmington Hills, MI 48334
248.488.2620
landmarkcres.com

LANDMARK COMMERCIAL REAL ESTATE SERVICES – Licensed Real Estate Brokers. The information above has been obtained from sources believed reliable. While we do not doubt its accuracy, we have not verified it and make no guarantee, warranty or representation about it. It is your responsibility to independently confirm its accuracy and completeness. Any projections, opinions, assumptions or estimates are used for example only and do not represent the current or future performance of the property. The value of this transaction to you depends on tax and other factors which should be evaluated by your tax, financial and legal advisors. You and your advisors should conduct a careful, independent investigation of the property to determine to your satisfaction, the suitability of the property for your needs.