

FOR SALE/LEASE
SHOPS OF MARQUETTE
US-41 & BRICKYARD RD, MARQUETTE, MI 49855



PROPERTY DETAILS

LOCATION:	US-41 & Brickyard Rd Marquette, MI 49855
PROPERTY TYPE:	Power Center
SALES PRICE:	Contact Broker
RENT:	Contact Broker
AVAILABLE SPACE:	1.5 AC (For Lease) ±1.8 AC (For Sale)
ZONING:	Commercial
TRAFFIC COUNT:	US-41 (31,207 CPD)

EXCLUSIVELY LISTED BY:



MAX J. GOLDMAN
Senior Director
mgoldman@landmarkcres.com
C: 734 646 5959
O: 248 488 2620

ANCHORS



TENANT ROSTER



HIGHLIGHTS

- Excellent Restaurant Site
- Located in Marquette's Best Retail Corridor

MICRO AERIAL



MACRO AERIAL

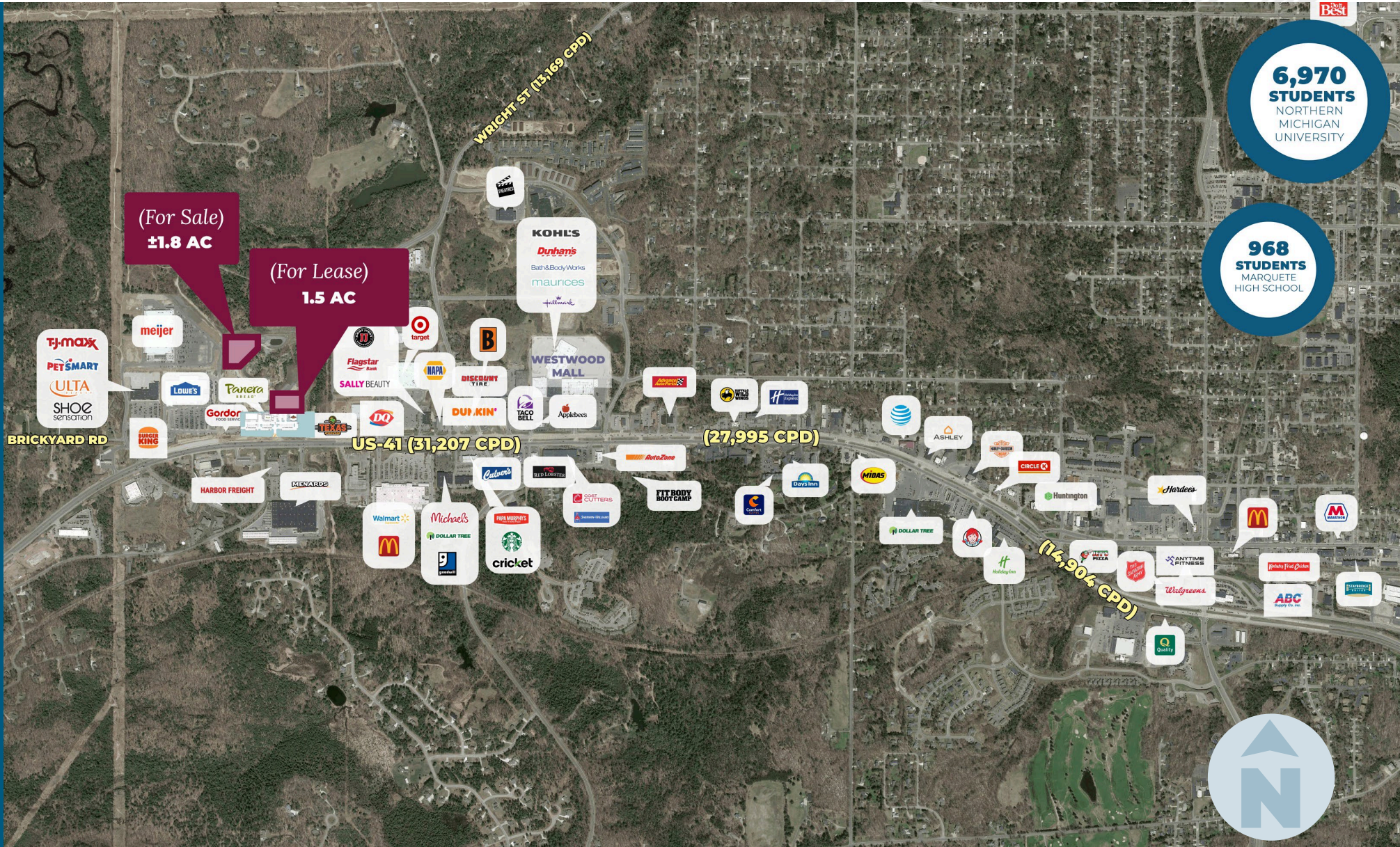

OVERALL CONCEPTUAL SITE PLAN

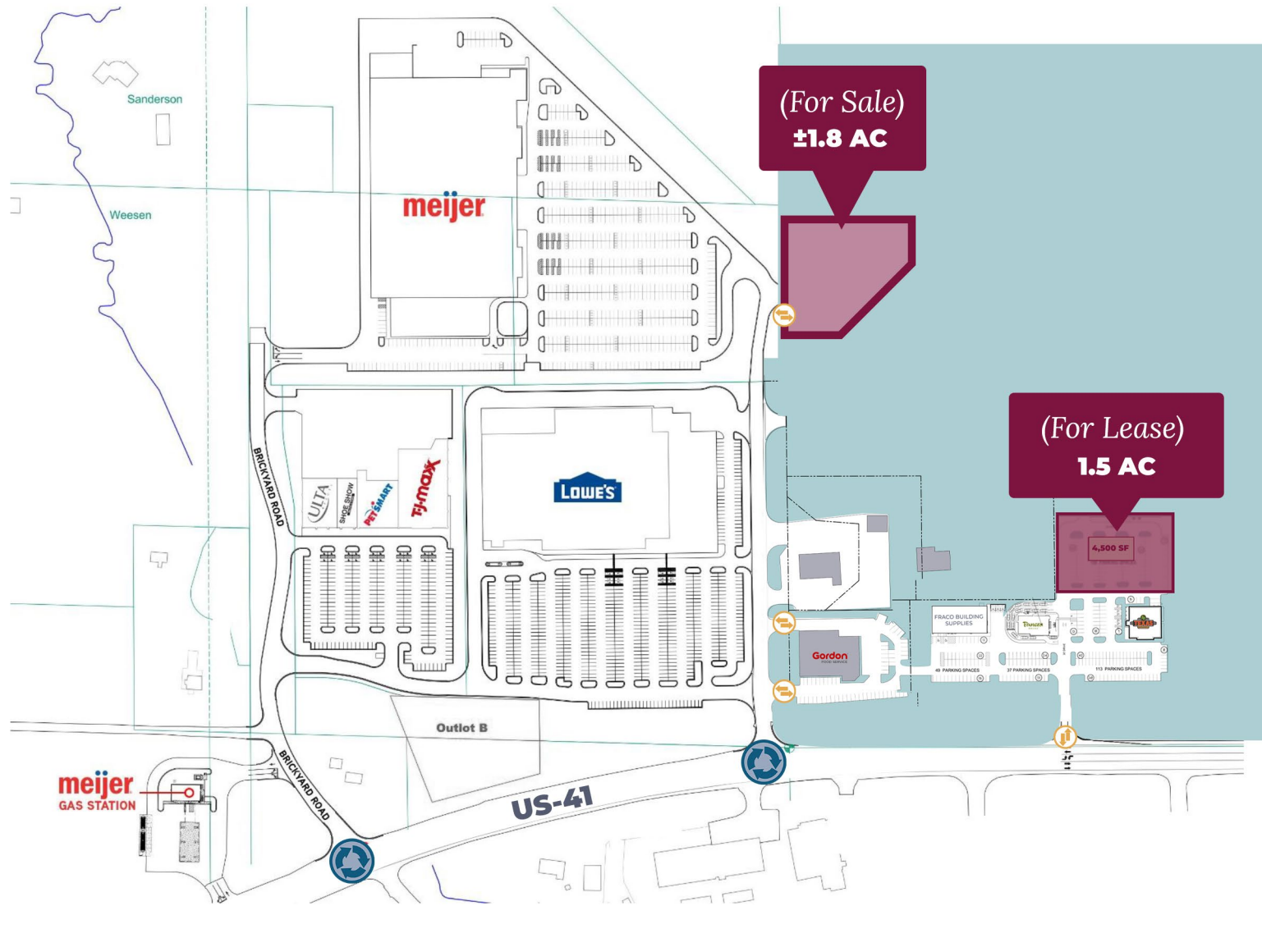

CONCEPTUAL SITE PLAN – FOR SALE | ±1.8 AC

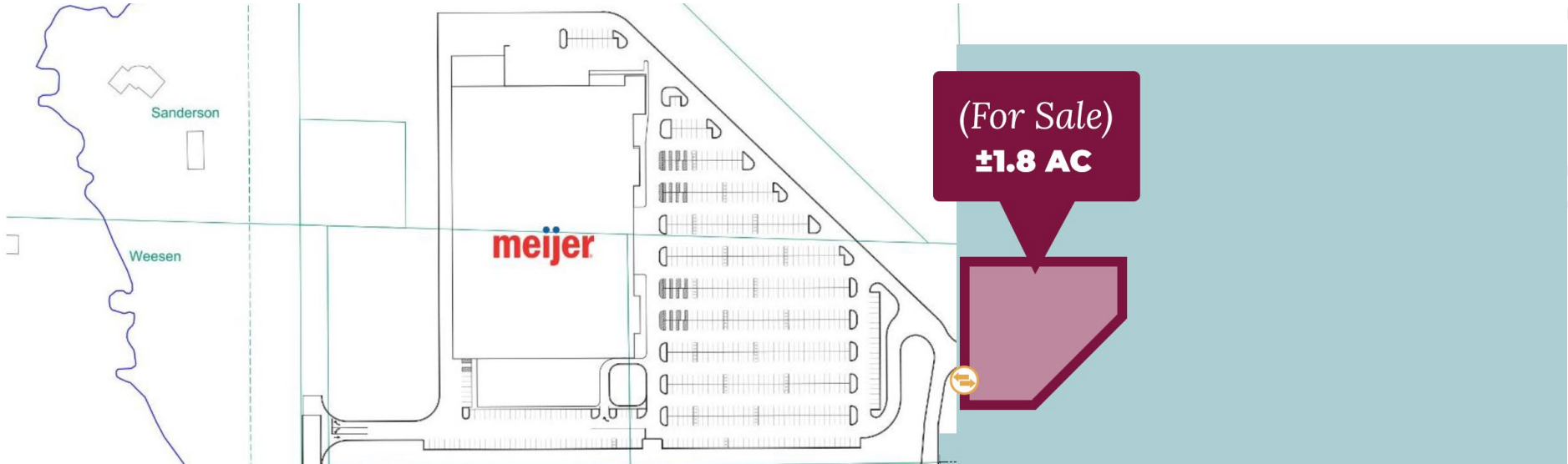

CONCEPTUAL SITE PLAN – FOR LEASE | 1 AC | 4,500 SF

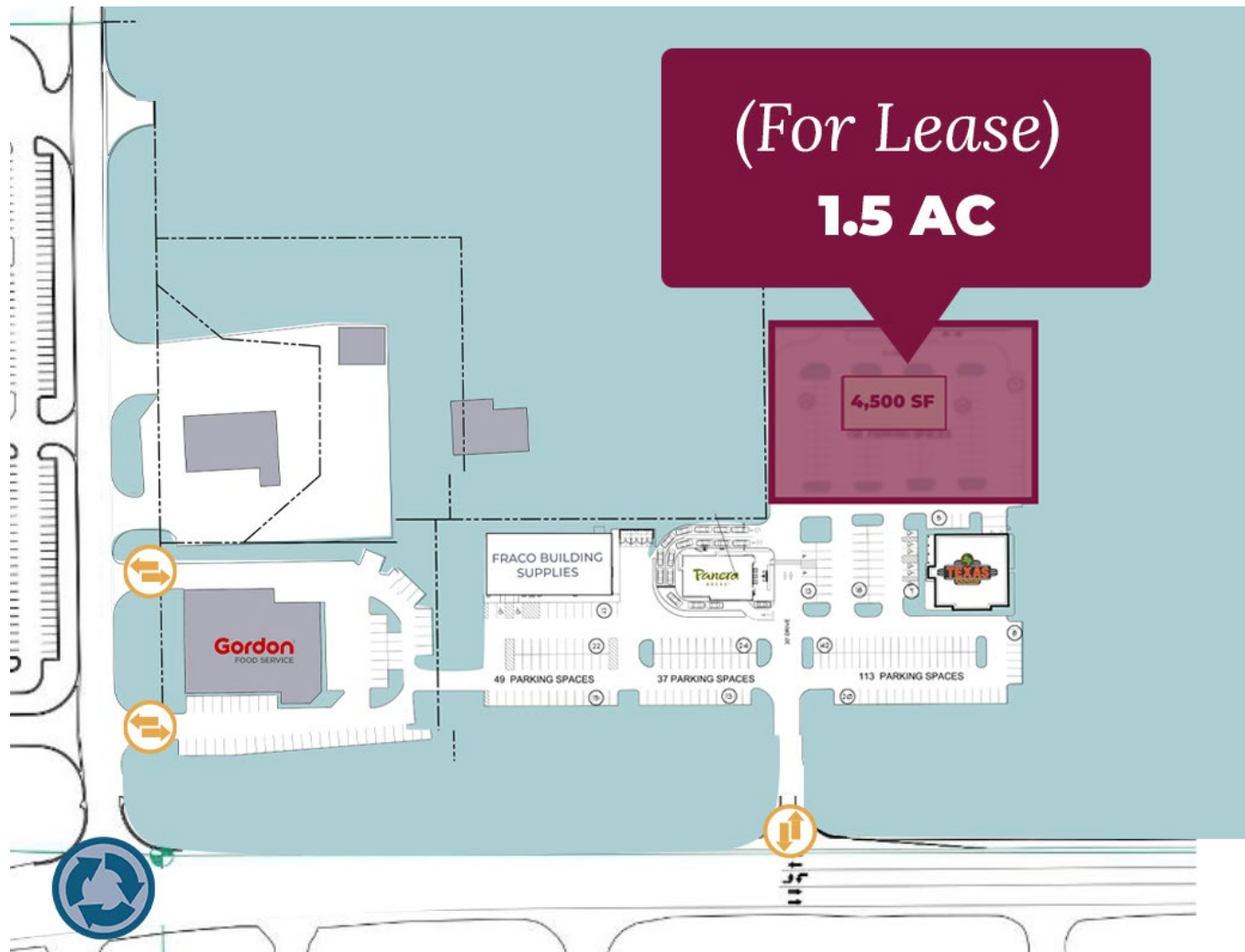

DEMOGRAPHICS

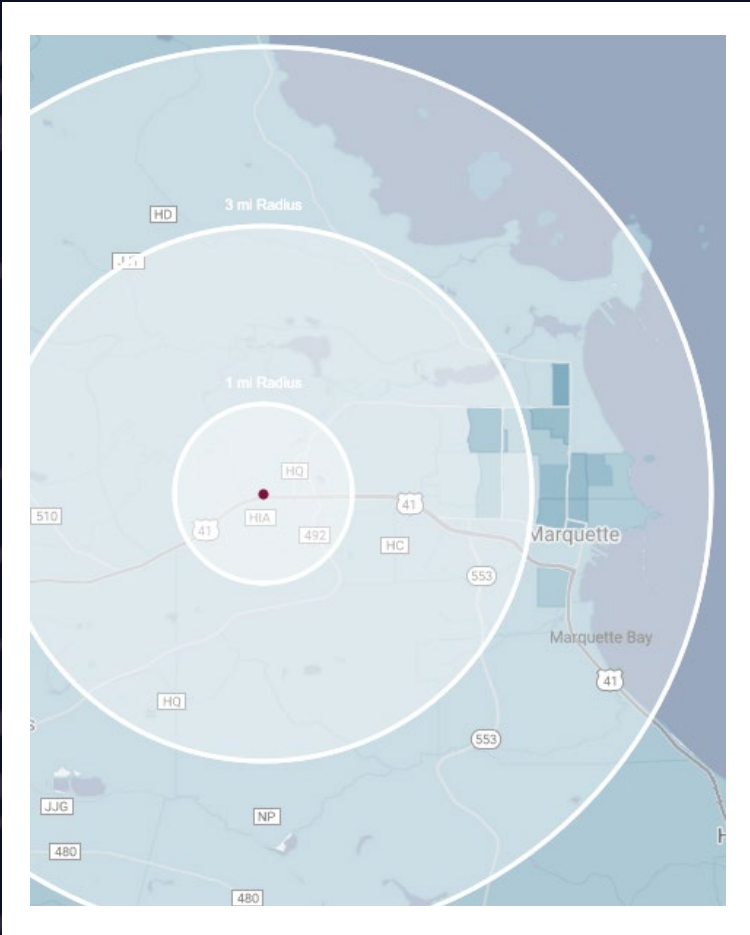

SHOPS OF MARQUETTE

US-41 & Brickyard Rd, Marquette, MI 49855

DEMOGRAPHICS

	10 MILE	25 MILE	75 MILE
POPULATION			
2023 Estimated Population	42,248	64,636	219,969
2028 Projected Population	42,548	64,821	216,728
2020 Census Population	42,485	64,717	220,310
2010 Census Population	42,804	65,527	223,706
Projected Annual Growth 2023 to 2028	0.1%	-	-0.3%
Historical Annual Growth 2010 to 2023	-0.1%	-0.1%	-0.1%
HOUSEHOLDS			
2023 Estimated Households	17,677	27,276	94,489
2028 Projected Households	17,286	26,552	88,570
2020 Census Households	17,619	27,053	93,788
2010 Census Households	17,283	26,795	93,357
Projected Annual Growth 2023 to 2028	-0.4%	-0.5%	-1.3%
Historical Annual Growth 2010 to 2023	0.2%	0.1%	-
RACE			
2023 Est. White	85.3%	88.4%	89.0%
2023 Est. Black	3.2%	2.3%	2.0%
2023 Est. Asian or Pacific Islander	6.2%	4.2%	3.3%
2023 Est. American Indian or Alaska Native	0.9%	0.9%	1.2%
2023 Est. Other Races	4.4%	4.2%	4.5%
INCOME			
2023 Est. Average Household Income	\$84,981	\$83,200	\$79,018
2023 Est. Median Household Income	\$63,896	\$63,243	\$57,416
2023 Est. Per Capita Income	\$36,900	\$36,015	\$34,681
BUSINESS			
2023 Est. Total Businesses	1,663	2,117	6,894
2023 Est. Total Employees	16,637	21,090	72,046

CONTACT US



**MAX J.
GOLDMAN**

Senior Director

mgoldman@landmarkcres.com

C: 734 646 5959

O: 248 488 2620

LANDMARK
COMMERCIAL ▲ REAL ESTATE ▲ SERVICES

30500 Northwestern Hwy, Suite 200
Farmington Hills, MI 48334
248.488.2620
landmarkcres.com

LANDMARK COMMERCIAL REAL ESTATE SERVICES – Licensed Real Estate Brokers. The information above has been obtained from sources believed reliable. While we do not doubt its accuracy, we have not verified it and make no guarantee, warranty or representation about it. It is your responsibility to independently confirm its accuracy and completeness. Any projections, opinions, assumptions or estimates are used for example only and do not represent the current or future performance of the property. The value of this transaction to you depends on tax and other factors which should be evaluated by your tax, financial and legal advisors. You and your advisors should conduct a careful, independent investigation of the property to determine to your satisfaction, the suitability of the property for your needs.