

FOR LEASE VILLAGE LAKES

300-320 TOWN CENTER BOULEVARD, WHITE LAKE, MI



PROPERTY DETAILS

LOCATION:	300-320 Towne Centre Boulevard, White Lake, MI 48386
PROPERTY TYPE:	Shopping Center
DATE AVAILABLE:	Immediately
RENT:	Contact Broker
NNN EXPENSE:	\$4.64/SF
AVAILABLE SPACE:	2,938
GROSS LEASABLE AREA:	174,273
TRAFFIC COUNT:	Highland Rd (25,384 CPD) Elizabeth Lake Rd (10,048 CPD)

EXCLUSIVELY LISTED BY:



**SCOTT J.
SONENBERG**

Director
ssonenberg@landmarkres.com
248 488 2620

CONTACT BROKER

\$4.64/SF

RENT

NNN

ANCHORS



TENANT ROSTER



HIGHLIGHTS

- Join JCPenney, Marshalls, Famous Footwear, Sally in this strong power center located in the heart of the M-59 corridor. The M-59 corridor is a major East/West thoroughfare that runs through most of metro Detroit. Village Lakes Shopping Center is adjacent to Kroger Marketplace, Hobby Lobby and ULTA. This Shopping Center draws from a 10 mile plus radius and has multiple ingress/egress points off of M-59.

MICRO AERIAL



PLANS

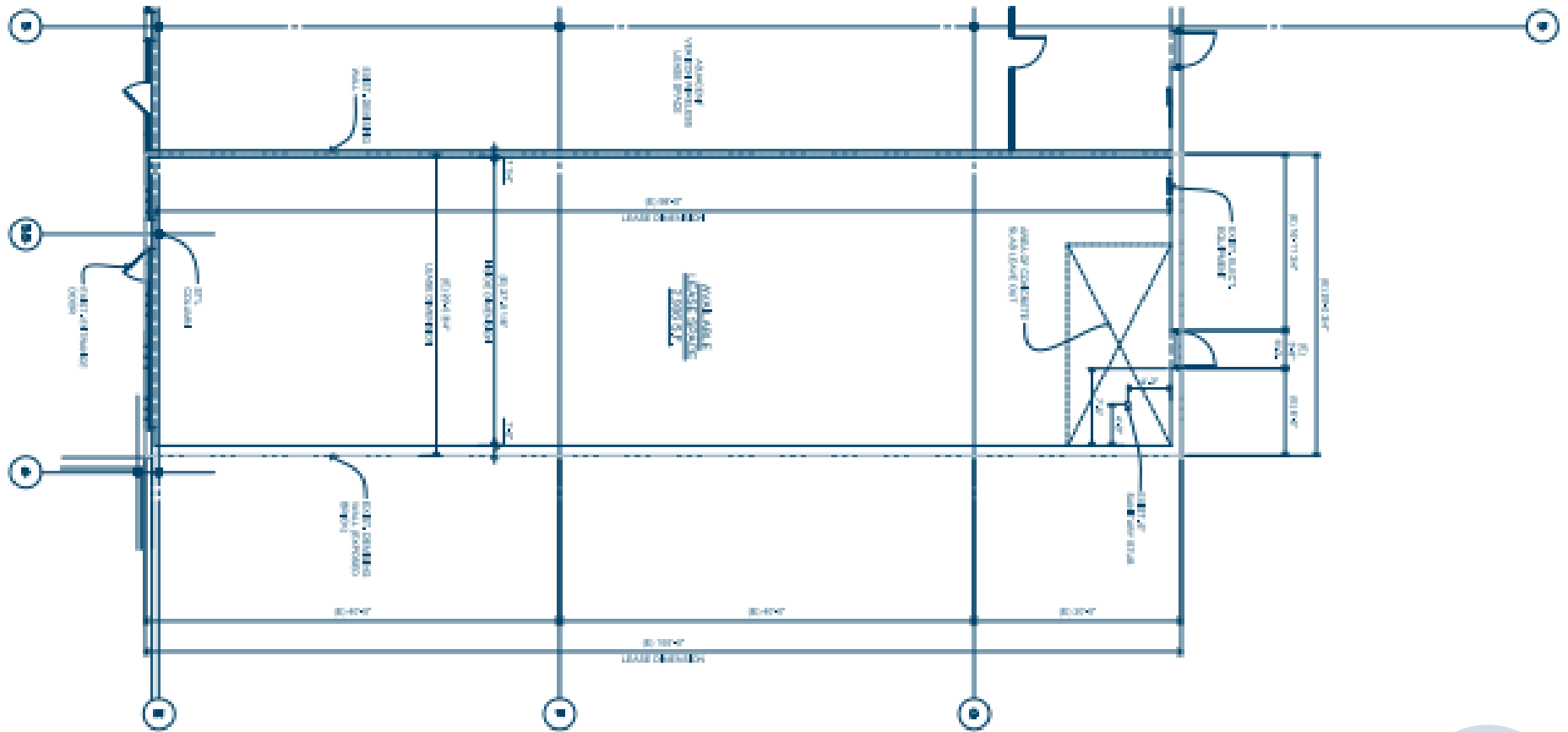

SITE PLAN

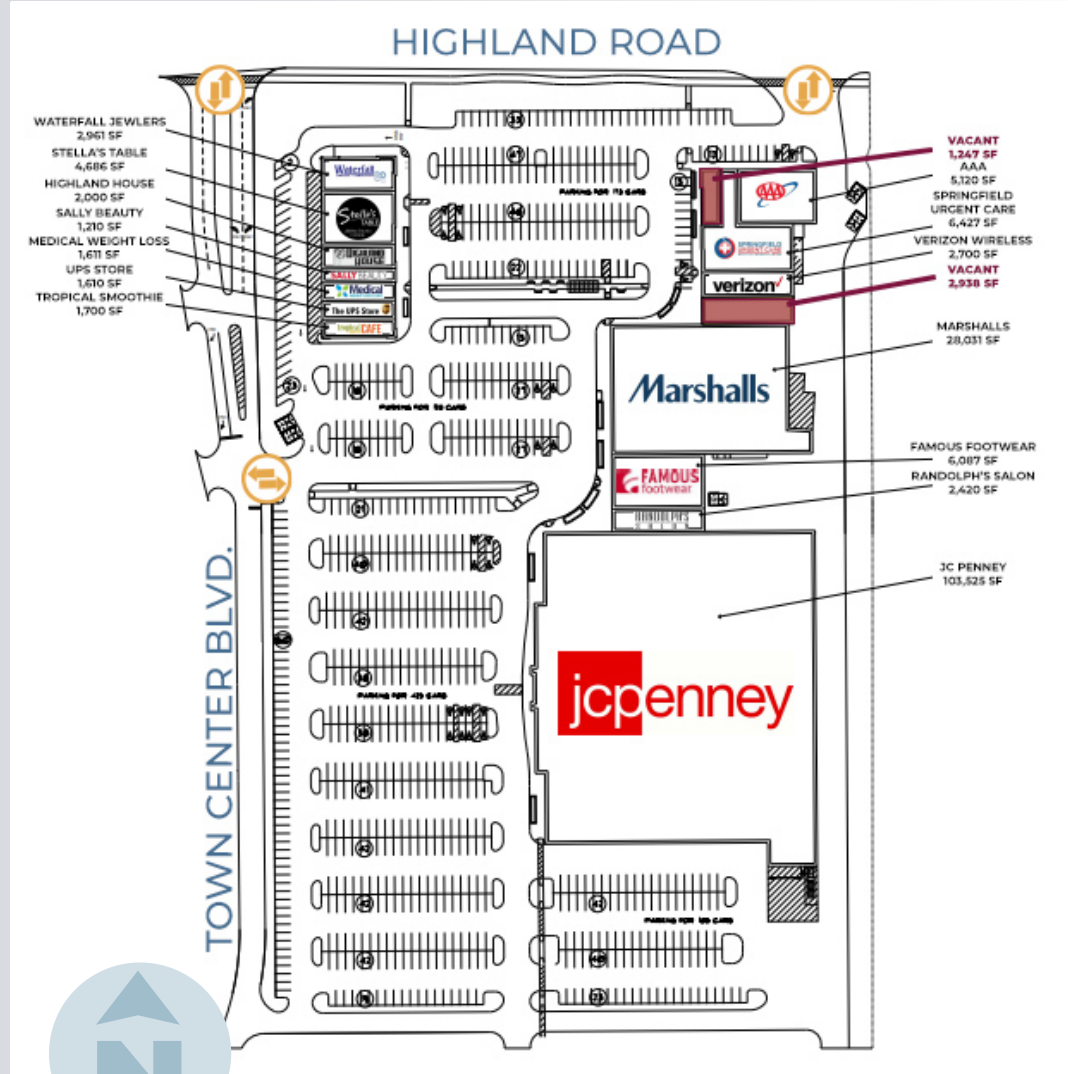

VILLAGE LAKES

300-320 Towne Centre Blvd., White Lake, MI

SIZE (SF)	TENANT
2,961	WATERFALL JEWELERS
4,686	STELLA'S TABLE
2,000	HIGHLAND HOUSE
1,210	SALLY BEAUTY
1,611	MEDICAL WEIGHT LOSS
1,610	UPS STORE
1,700	TROPICAL SMOOTHIE CAFE
1,247	AVAILABLE
5,120	AAA
6,427	SPRINGFIELD URGENT CARE
2,700	VERIZON WIRELESS
2,938	AVAILABLE
28,031	MARSHALLS
6,087	FAMOUS FOOTWEAR
2,420	RANDOLPH'S SALON
103,525	JCPENNEY

DEMOGRAPHICS



VILLAGE LAKES

300-320 Town Center Blvd., White Lake, MI

DEMOGRAPHICS

POPULATION

	1 MILE	3 MILE	5 MILE
2023 Estimated Population	1,868	27,392	79,137
2028 Projected Population	1,905	27,596	79,496
2020 Census Population	1,790	27,433	79,224
2010 Census Population	1,719	25,688	75,776
Projected Annual Growth 2023 to 2028	0.4%	0.1%	-
Historical Annual Growth 2010 to 2023	0.7%	0.5%	0.3%

HOUSEHOLDS

2023 Estimated Households	745	10,568	30,868
2028 Projected Households	761	10,650	31,002
2020 Census Households	706	10,438	30,529
2010 Census Households	662	9,636	28,572
Projected Annual Growth 2023 to 2028	0.4%	0.2%	-
Historical Annual Growth 2010 to 2023	1.0%	0.7%	0.6%

RACE

2023 Est. White	92.7%	90.4%	89.4%
2023 Est. Black	1.8%	2.4%	3.2%
2023 Est. Asian or Pacific Islander	1.2%	1.9%	2.1%
2023 Est. American Indian or Alaska Native	0.1%	0.2%	0.2%
2023 Est. Other Races	4.2%	5.0%	5.0%

INCOME

2023 Est. Average Household Income	\$109,414	\$133,183	\$130,777
2023 Est. Median Household Income	\$92,584	\$108,189	\$105,150
2023 Est. Per Capita Income	\$43,752	\$51,438	\$51,059

BUSINESS

2023 Est. Total Businesses	85	584	2,053
2023 Est. Total Employees	619	4,074	14,337

CONTACT US



**SCOTT J.
SONENBERG**

Director

ssonenberg@landmarkcres.com

248 488 2620

LANDMARK
COMMERCIAL ▲ REAL ESTATE ▲ SERVICES

30500 Northwestern Hwy, Suite 200
Farmington Hills, MI 48334
248.488.2620
landmarkcres.com

LANDMARK COMMERCIAL REAL ESTATE SERVICES – Licensed Real Estate Brokers. The information above has been obtained from sources believed reliable. While we do not doubt its accuracy, we have not verified it and make no guarantee, warranty or representation about it. It is your responsibility to independently confirm its accuracy and completeness. Any projections, opinions, assumptions or estimates are used for example only and do not represent the current or future performance of the property. The value of this transaction to you depends on tax and other factors which should be evaluated by your tax, financial and legal advisors. You and your advisors should conduct a careful, independent investigation of the property to determine to your satisfaction, the suitability of the property for your needs.