

FOR LEASE

FREESTANDING BUILDING W/TWO OVERHEAD DOORS

19690 E 9 MILE RD, ST CLAIR SHORES, MI 48080



PROPERTY DETAILS

LOCATION: 19690 E 9 Mile Rd
St Clair Shores, MI 48080

PROPERTY TYPE: Freestanding

DATE AVAILABLE: Immediately

RENT: \$18.00/SF NNN

NNN EXPENSE: Contact Broker

BUILDING SIZE: 3,284 SF

LOT SIZE: 0.35 AC

AVAILABLE SPACE: 1,214 SF – 3,284 SF

ZONING: L-1 (Light Industrial)

TRAFFIC COUNT: 9 Mile Rd (23,256 CPD)
I-94 (124,668 CPD)

\$18.00/SF NNN

Contact Broker

RENT

NNN

HIGHLIGHTS

- Highly Visible Freestanding Location
- Large Pylon Signage
- Two Overhead Doors
- Onsite Parking (West & East of Building)
- Close Access to I-94 & I-696

EXCLUSIVELY LISTED BY:



**ANTHONY J.
VITALE**

Director
avitale@landmarkcres.com
248 488 2620

MICRO AERIAL



MACRO AERIAL

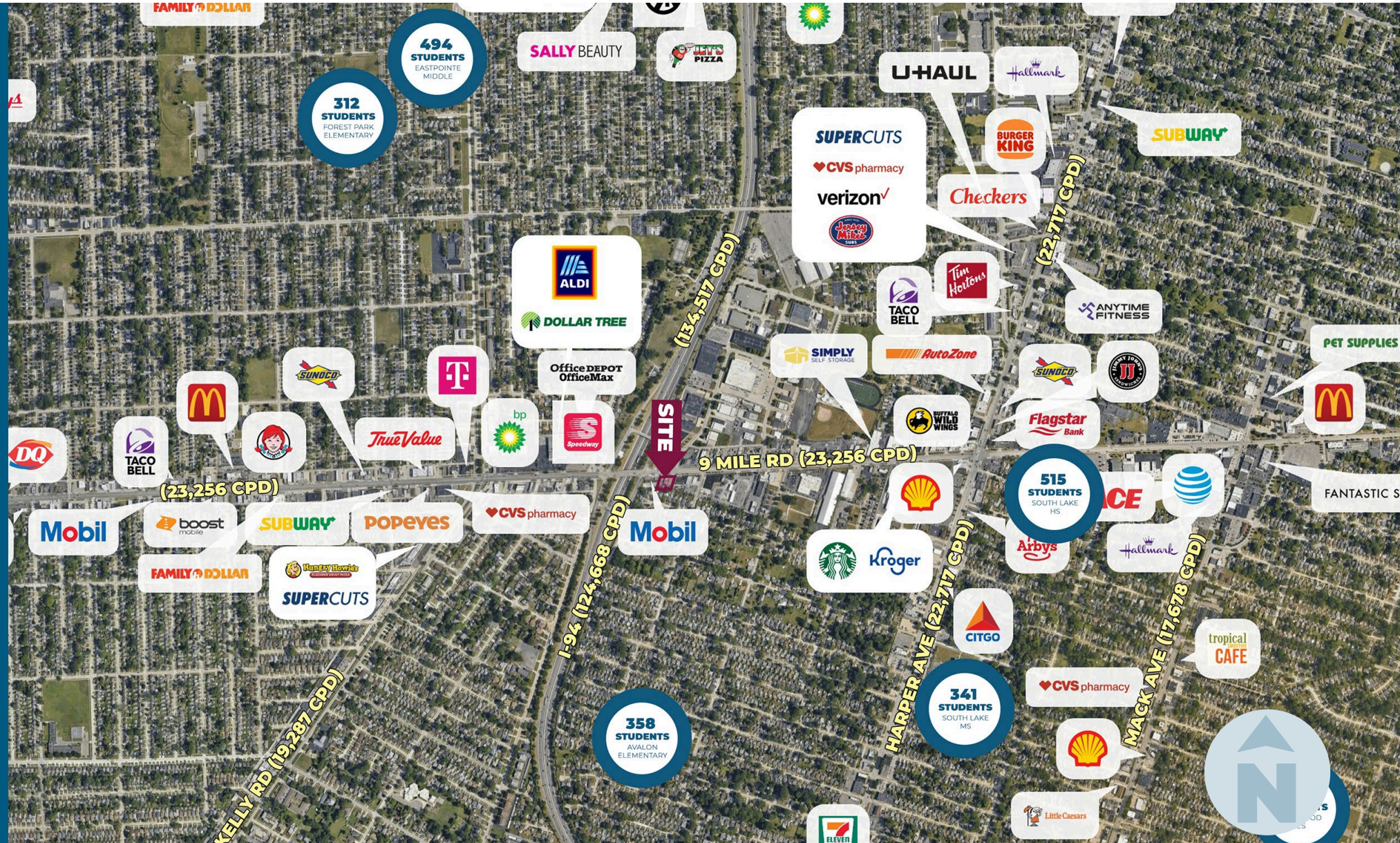

SITE PHOTOS



SITE PHOTOS



Floor plan

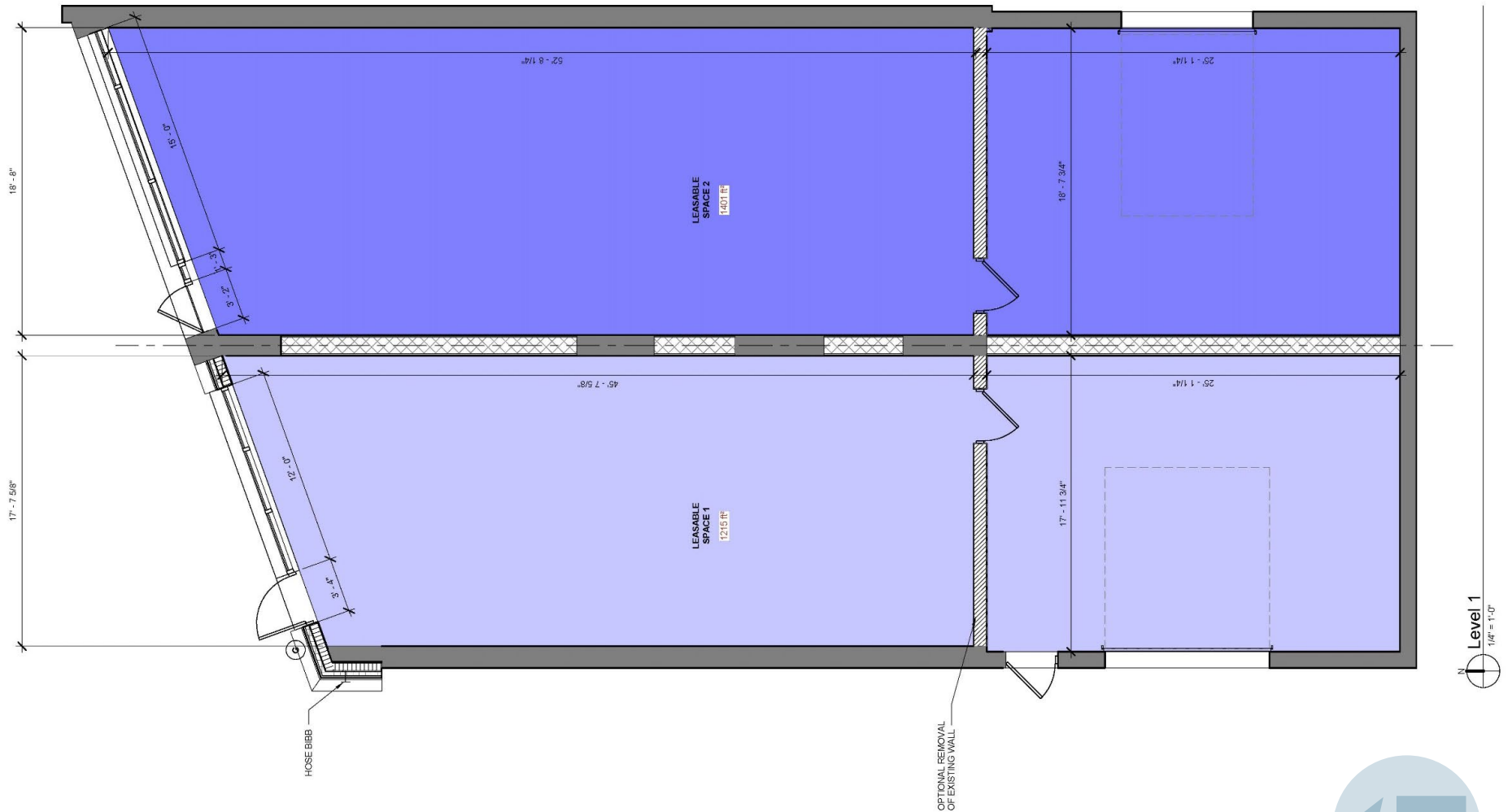

Level 1
1/4" = 1'-0"



SURVEY



DEMOGRAPHICS

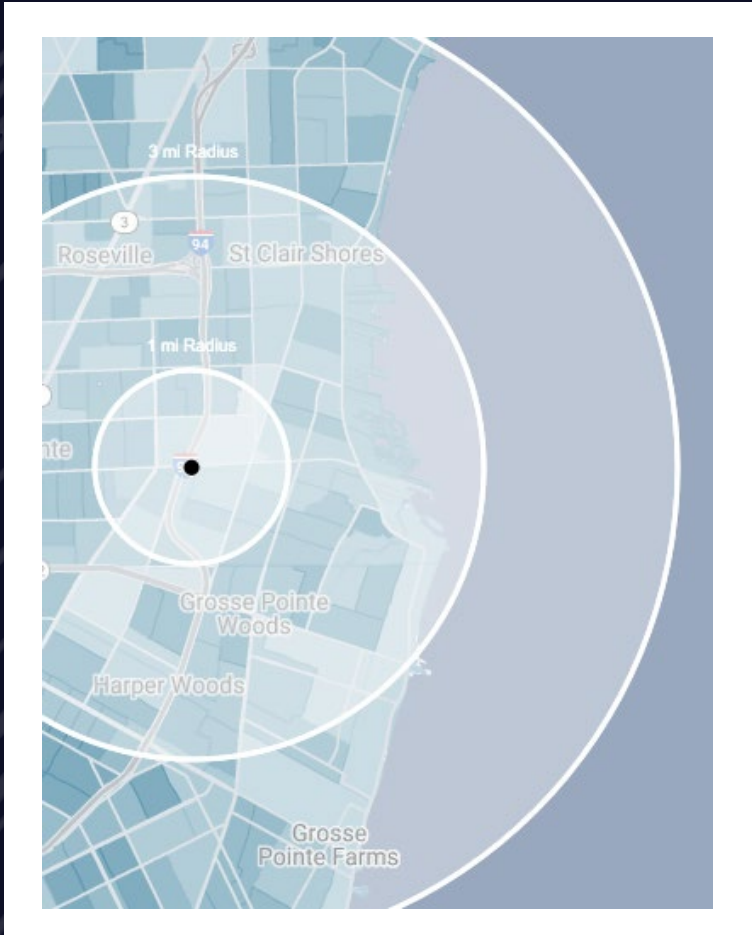

FREESTANDING BUILDING

19690 E 9 Mile Rd, St Clair Shores, MI 48080

DEMOGRAPHICS

POPULATION	1 MILE	3 MILE	5 MILE
2023 Estimated Population	17,443	149,787	303,866
2028 Projected Population	17,281	148,180	301,546
2020 Census Population	17,609	151,139	305,136
2010 Census Population	17,241	150,095	314,342
Projected Annual Growth 2023 to 2028	-0.2%	-0.2%	-0.2%
Historical Annual Growth 2010 to 2023	-	-	-0.3%
HOUSEHOLDS			
2023 Estimated Households	7,426	61,850	122,204
2028 Projected Households	7,457	61,672	121,952
2020 Census Households	7,411	61,709	121,405
2010 Census Households	7,168	60,475	122,418
Projected Annual Growth 2023 to 2028	-	-	-
Historical Annual Growth 2010 to 2023	0.3%	0.2%	-
RACE			
2023 Est. White	59.3%	59.4%	54.2%
2023 Est. Black	34.9%	34.6%	39.5%
2023 Est. Asian or Pacific Islander	1.1%	1.6%	2.0%
2023 Est. American Indian or Alaska Native	0.2%	0.2%	0.2%
2023 Est. Other Races	4.5%	4.4%	4.2%
INCOME			
2023 Est. Average Household Income	\$86,497	\$89,356	\$89,305
2023 Est. Median Household Income	\$67,234	\$67,242	\$65,467
2023 Est. Per Capita Income	\$36,839	\$36,949	\$35,989
BUSINESS			
2023 Est. Total Businesses	761	4,407	9,397
2023 Est. Total Employees	6,032	31,454	84,297

CONTACT US



**ANTHONY J.
VITALE**

Director

avitale@landmarkcres.com

248 488 2620

LANDMARK
COMMERCIAL ▲ REAL ESTATE ▲ SERVICES

30500 Northwestern Hwy, Suite 200
Farmington Hills, MI 48334
248.488.2620
landmarkcres.com

LANDMARK COMMERCIAL REAL ESTATE SERVICES – Licensed Real Estate Brokers. The information above has been obtained from sources believed reliable. While we do not doubt its accuracy, we have not verified it and make no guarantee, warranty or representation about it. It is your responsibility to independently confirm its accuracy and completeness. Any projections, opinions, assumptions or estimates are used for example only and do not represent the current or future performance of the property. The value of this transaction to you depends on tax and other factors which should be evaluated by your tax, financial and legal advisors. You and your advisors should conduct a careful, independent investigation of the property to determine to your satisfaction, the suitability of the property for your needs.