

FOR LEASE  
**PREMIER RETAIL ON M.A.C. AVE**

205 M.A.C. AVE, EAST LANSING, MI 48823



850 SF  
AVAILABLE

**SIGNAGE**

# PROPERTY DETAILS

<b>LOCATION:</b>	205 M.A.C. Ave, East Lansing, MI 48823	
<b>PROPERTY TYPE:</b>	Freestanding	
<b>DATE AVAILABLE:</b>	Immediately	
<b>RENT:</b>	\$33.00/SF Gross	
<b>BUILDING SIZE:</b>	850 SF	
<b>AVAILABLE SPACE:</b>	850 SF	First Floor
<b>ZONING:</b>	B3	
<b>TRAFFIC COUNT:</b>	M.A.C. Ave (4,749 CPD) Grand River Ave (23,383 CPD)	

EXCLUSIVELY LISTED BY:



**ROCCO J.  
GALATI**

[rgalati@landmarkcres.com](mailto:rgalati@landmarkcres.com)  
248 488 2620

850 SF

\$33.00/SF GROSS

**BUILDING SIZE**

**RENT**

## TENANT ROSTER



## HIGHLIGHTS

- Prime location on the NW corner of Grand River & M.A.C. Ave. – East Lansing’s main retail corridor
- Steps from Michigan State University campus
- Access to 50,000+ students, faculty, and staff
- Surrounded by top-performing restaurants, bars, and national retailers
- Located in a dense, walkable downtown environment
- Positioned in one of Michigan’s strongest college markets

# MICRO AERIAL

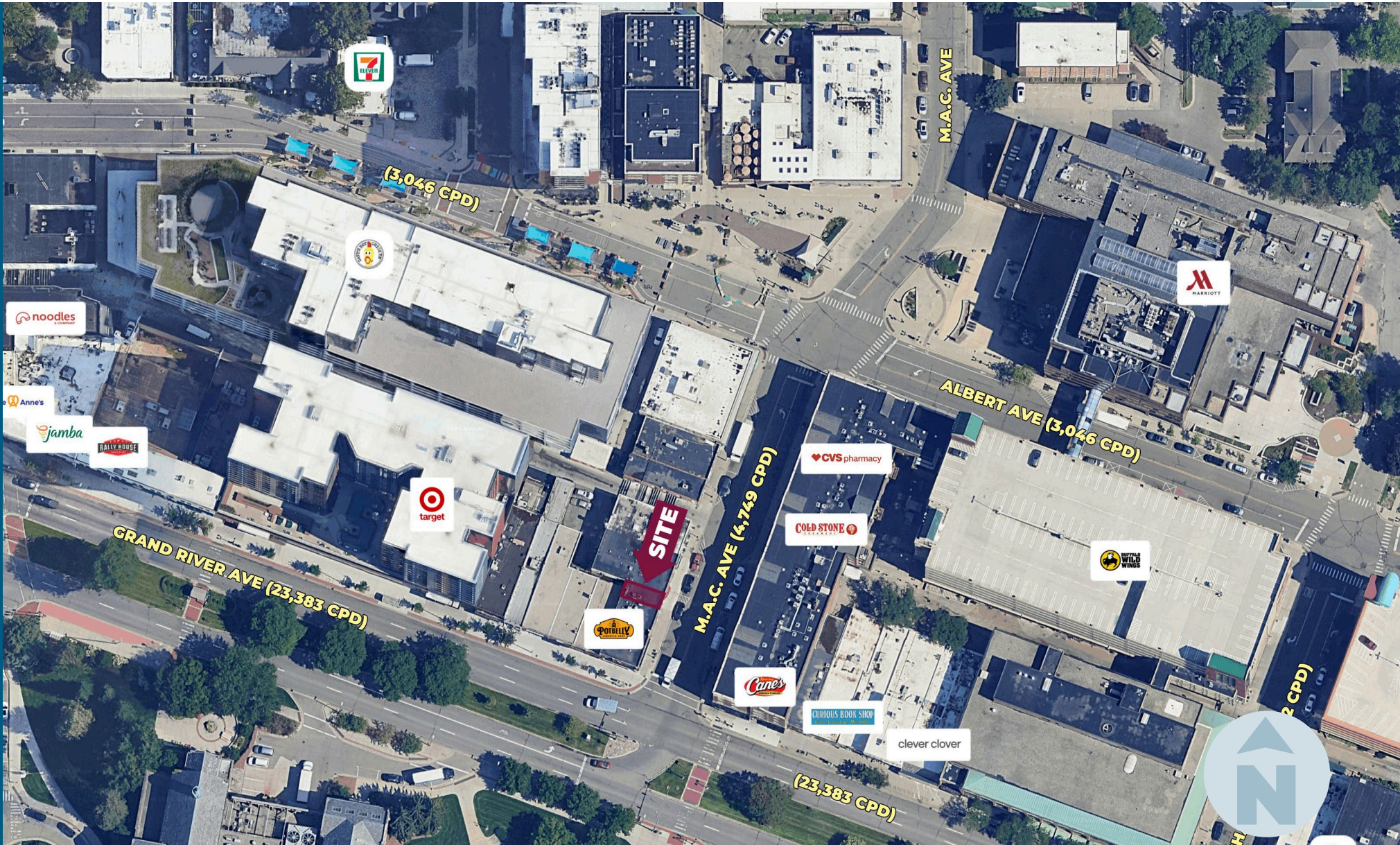



# DEMOGRAPHICS

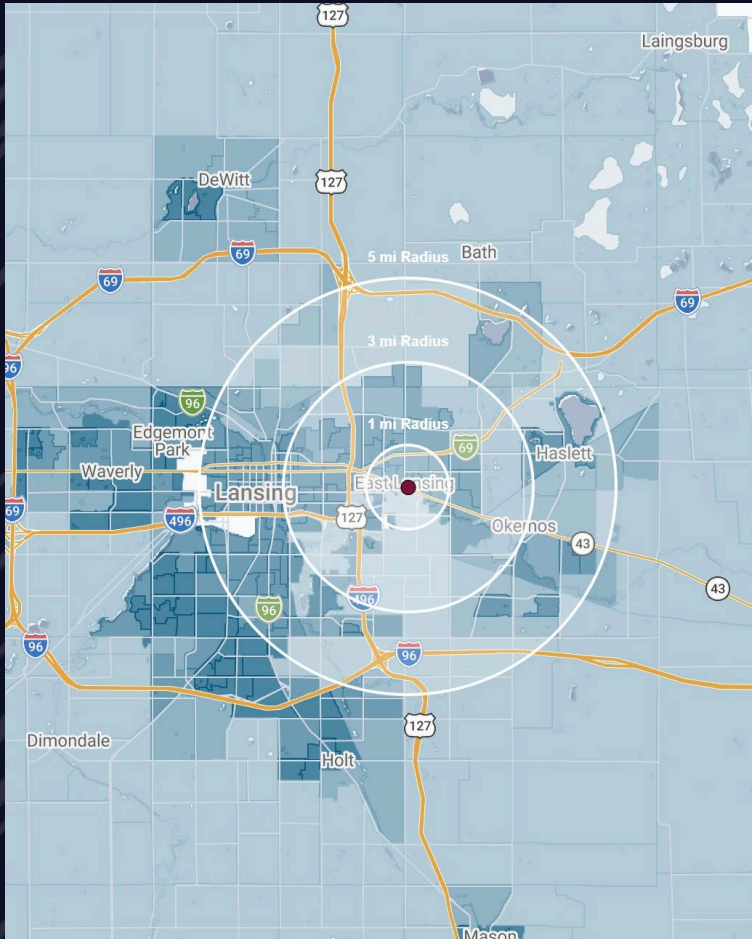

## PREMIER RETAIL ON M.A.C. AVE

205 M.A.C. Ave, East Lansing, MI 48823

# DEMOGRAPHICS

<b>POPULATION</b>	<b>1 MILE</b>	<b>3 MILE</b>	<b>5 MILE</b>
2025 Estimated Population	26,278	88,352	176,590
2030 Projected Population	26,814	88,144	175,738
2020 Census Population	25,888	85,382	168,940
2010 Census Population	25,950	83,709	166,005
Projected Annual Growth 2025 to 2030	0.4%	-	-
Historical Annual Growth 2010 to 2025	-	0.4%	0.4%
<b>HOUSEHOLDS</b>			
2025 Estimated Households	7,090	33,463	72,888
2030 Projected Households	7,616	34,530	75,166
2020 Census Households	6,688	32,054	68,984
2010 Census Households	6,061	30,399	66,090
Projected Annual Growth 2025 to 2030	1.5%	0.6%	0.6%
Historical Annual Growth 2010 to 2025	1.1%	0.7%	0.7%
<b>RACE</b>			
2025 Est. White	72.5%	67.4%	67.2%
2025 Est. Black	13.4%	13.3%	13.2%
2025 Est. Asian or Pacific Islander	7.8%	10.4%	9.7%
2025 Est. American Indian or Alaska Native	0.3%	0.4%	0.4%
2025 Est. Other Races	6.0%	8.5%	9.5%
<b>INCOME</b>			
2025 Est. Average Household Income	\$70,151	\$86,479	\$91,239
2025 Est. Median Household Income	\$54,718	\$62,414	\$67,689
2025 Est. Per Capita Income	\$25,260	\$35,578	\$39,139
<b>BUSINESS</b>			
2025 Est. Total Businesses	612	2,676	6,705
2025 Est. Total Employees	7,594	33,022	89,205

## CONTACT US



**ROCCO J.  
GALATI**

*rgalati@landmarkcres.com*  
**248 488 2620**

**LANDMARK**  
COMMERCIAL ▲ REAL ESTATE ▲ SERVICES

30500 Northwestern Hwy, Suite 200  
Farmington Hills, MI 48334  
248.488.2620  
[landmarkcres.com](http://landmarkcres.com)

LANDMARK COMMERCIAL REAL ESTATE SERVICES – Licensed Real Estate Brokers. The information above has been obtained from sources believed reliable. While we do not doubt its accuracy, we have not verified it and make no guarantee, warranty or representation about it. It is your responsibility to independently confirm its accuracy and completeness. Any projections, opinions, assumptions or estimates are used for example only and do not represent the current or future performance of the property. The value of this transaction to you depends on tax and other factors which should be evaluated by your tax, financial and legal advisors. You and your advisors should conduct a careful, independent investigation of the property to determine to your satisfaction, the suitability of the property for your needs.